

ZONE	REV	DESCRIPTION	REVISION	DATE	APPROVED
-	-	INITIAL RELEASE		110704	

NOTES: UNLESS OTHERWISE SPECIFIED

1. INTERPRET DRAWING IAW THE GLOBAL PROFESSIONAL PUBLICATIONS "DRAWING REQUIREMENTS MANUAL", EIGHTH EDITION.
2. INTERPRET DIMENSIONS AND TOLERANCES IAW ANSI Y14.5M - 1982.
3. INTERPRET ABBREVIATIONS IAW MIL-STD-12.

△ 4. RATED AT 100 WATTS TO 4 KW

5. WEIGHT = 3 POUNDS (1.36 KG)

△ 6. POWER SUPPLY OUTPUT SWITCHING IS ACTUATED BY 24 VDC INPUTS. A SEPARATE 1/2 RACK REMOTE CONTROL UNIT IS AVAILABLE. CONTACT FACTORY.

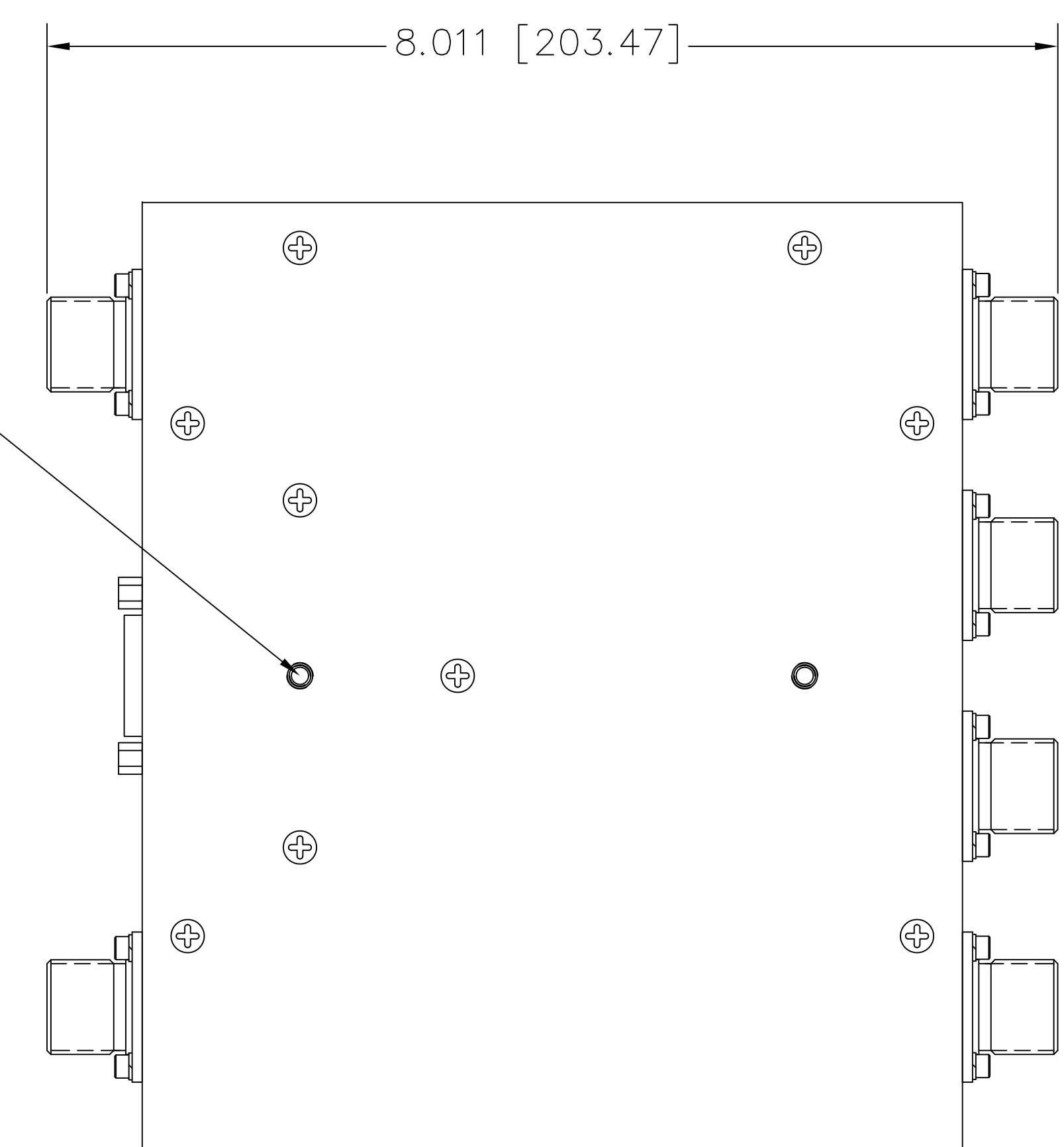
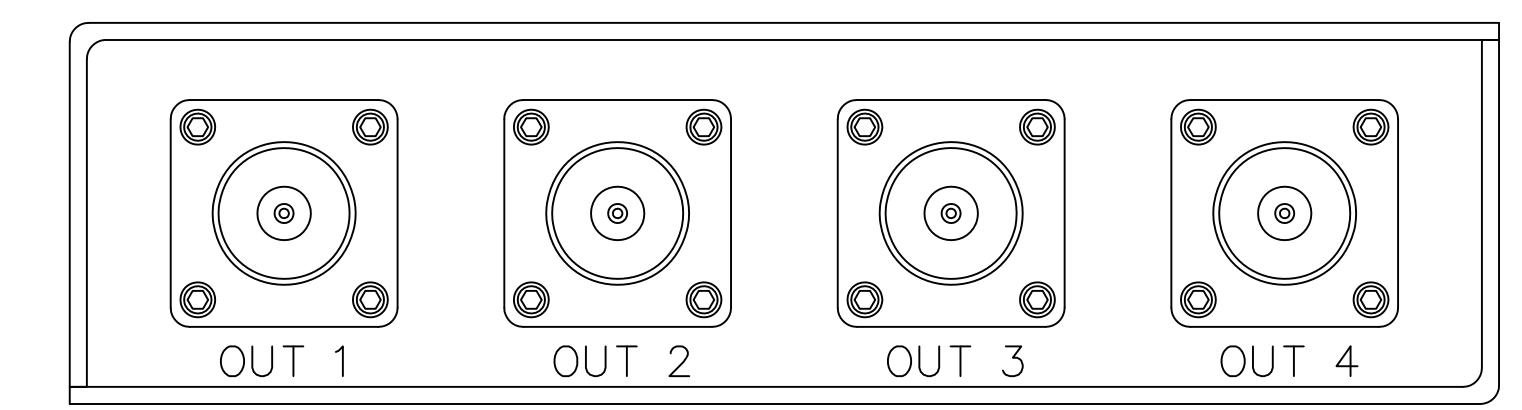
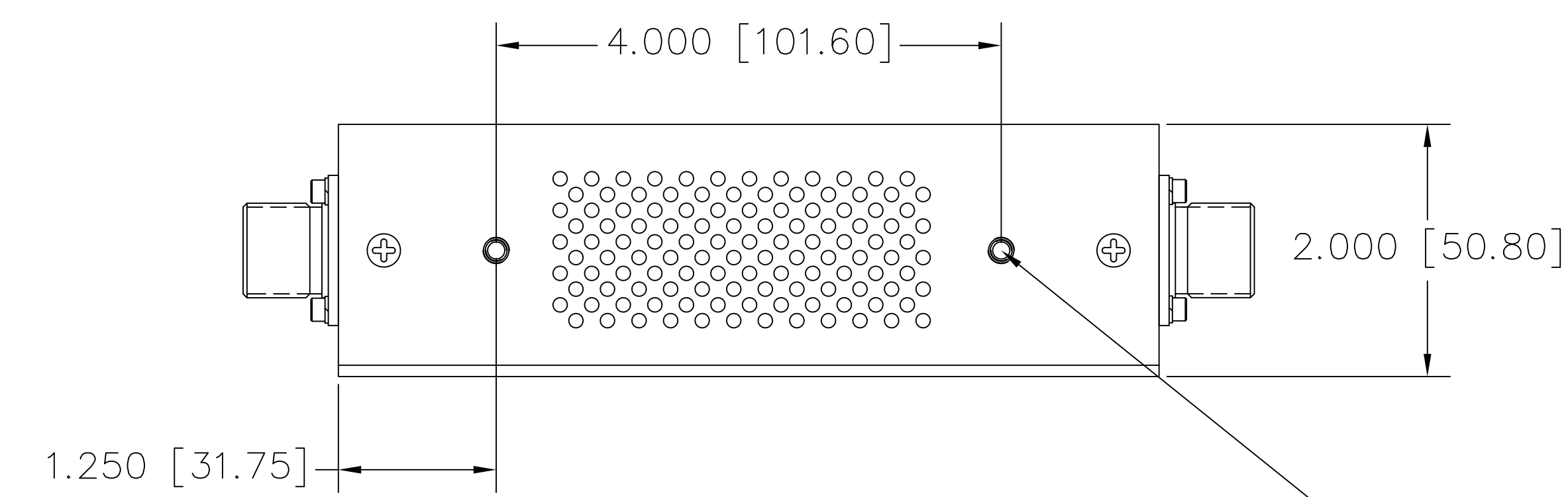
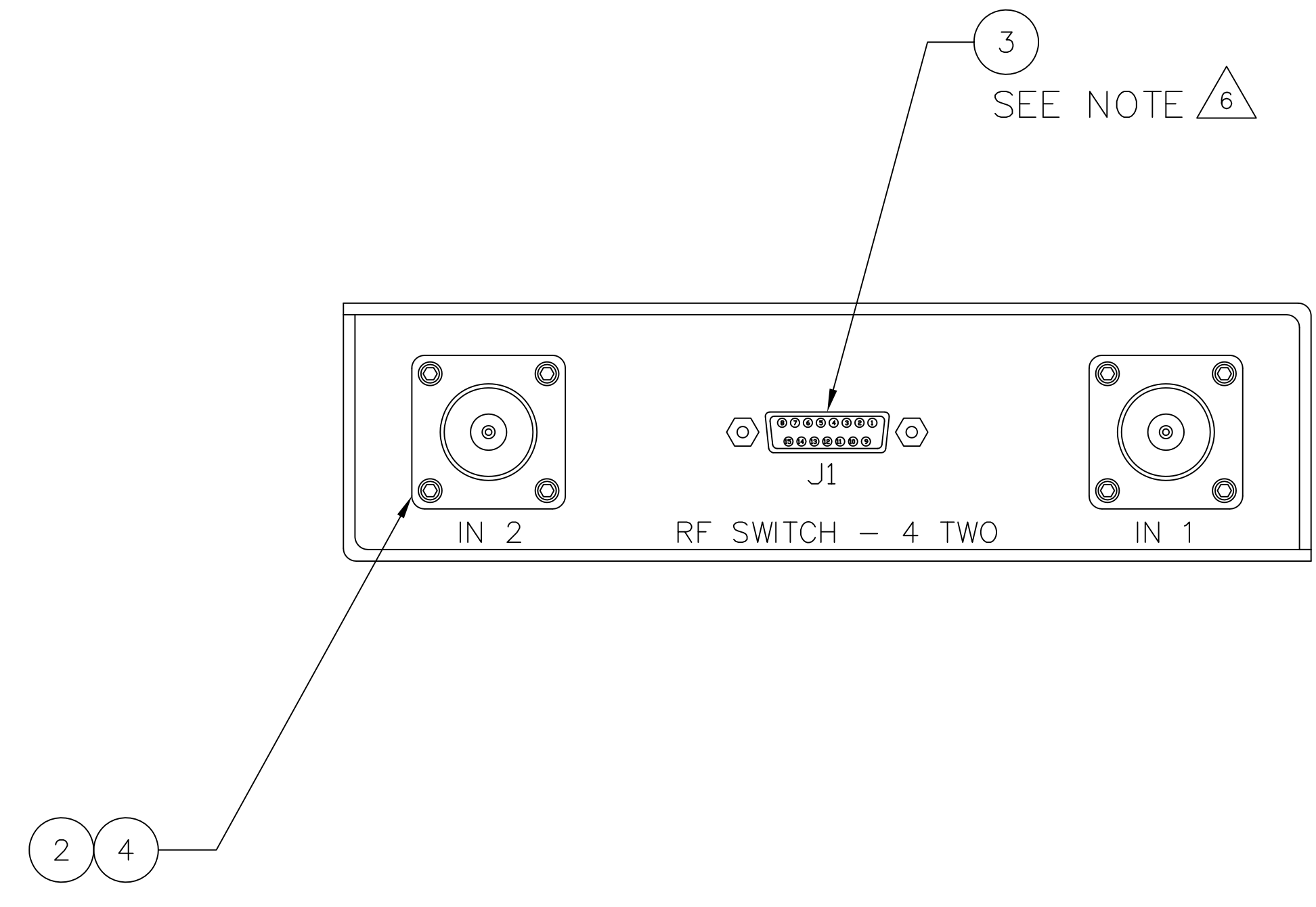
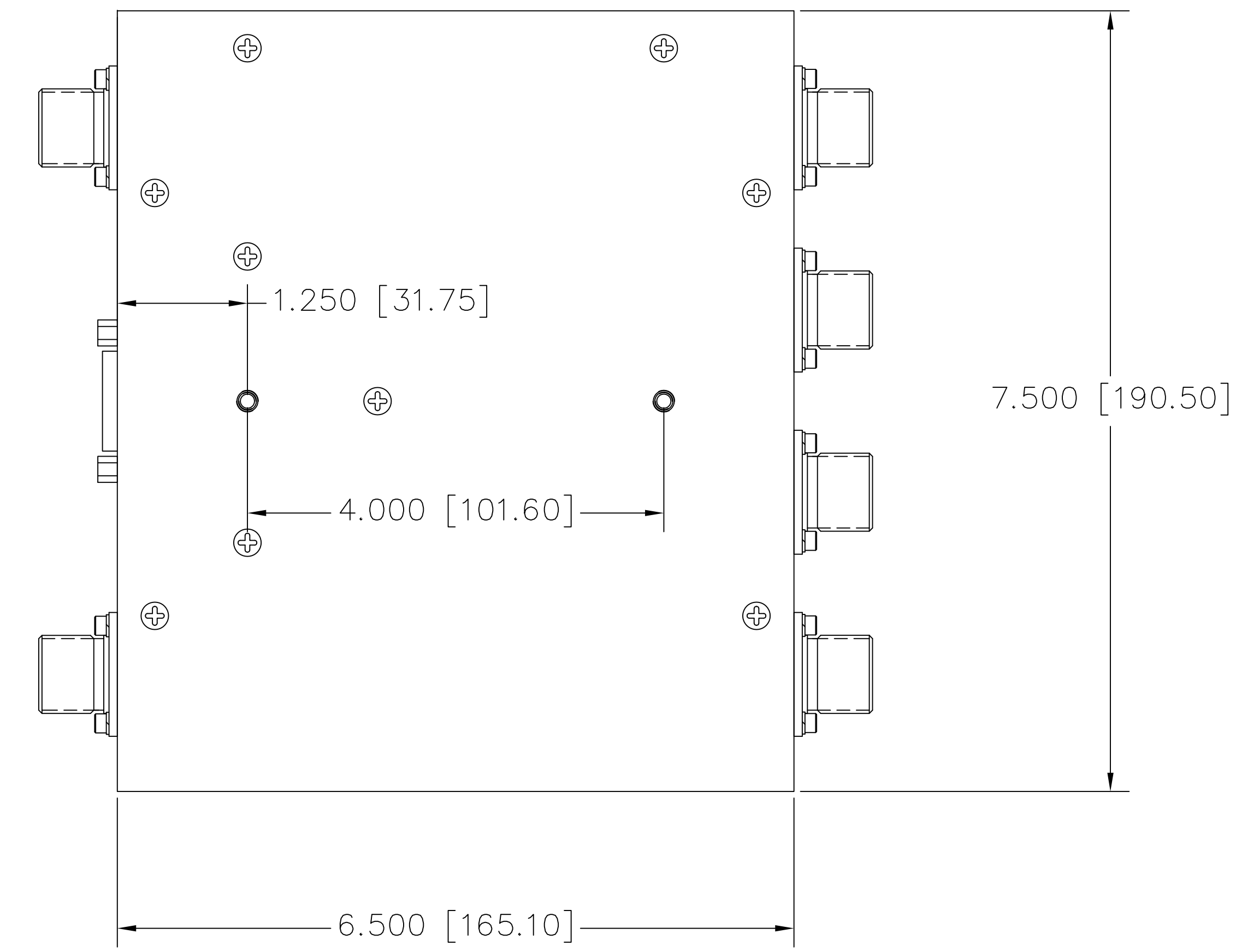

8-32 TAPPED HOLES 2X TOP AND BOTTOM TO ALLOW ATTACHMENT OF USER SUPPLIED MOUNTING BRACKETS.

8-32 TAPPED HOLES 2X BOTH SIDES TO ALLOW ATTACHMENT OF USER SUPPLIED MOUNTING BRACKETS

-1 VERSION SHOWN

QUANTITY PER ASSEMBLY	QUANTITY PER ASSEMBLY	CAGE CODE	PART OR IDENTIFYING NO.	NOMENCLATURE OR DESCRIPTION	MATERIAL SPECIFICATION	ZONE	ITEM NO
6			-	CONNECTOR, FEMALE UHF (SO 239)			4
	1		-	CONNECTOR, DB-15, FEMALE			3
	6		-	CONNECTOR, FEMALE HN			2
	1		00002384	RF/DC SWITCH, 2 INPUTS, 4 OUTPUTS			1

UNLESS OTHERWISE SPECIFIED DIMENSIONS ARE IN INCHES TOLERANCES ARE:		DRAWN: J. MILLER 11/07/04		MATERIALS SCIENCE, INC. Vocuum Grid Thin Film Technology RF and Microwave Dev. Dept. 1A B204	
DECIMALS: .010	ANGLES: 3/32	THIS DRAWING CONTAINS PROPRIETARY INFORMATION AND ANY REPRODUCTION, DISCLOSURE OR USE OF THIS DRAWING WITHOUT WRITTEN PERMISSION FROM MATERIALS SCIENCE, INC. IS EXPRESSLY PROHIBITED.			
FRACTIONS: XX 1/32	FINISH: N/A	NEXT ASSEMBLY		USED ON	
DO NOT SCALE DRAWING		APPLICATION		SCALE: 1/1	
SIZE: E		CAGE CODE: 00002384		REV: -	
SHEET: 1 OF 1		DATE: 11/07/04		DRAWN BY: J. MILLER	

00002384